



شرکت مهندسی صباتام صنعت

weflo

کاتالوگ

CATÁLOGO DE FABRICANTE

WEFLO VALVE COMPANY LTD.

WEFLO®

WEFLO VALVE CO., LTD

IPC BRASIL e WEFLO

QUALIDADE , INOVAÇÃO , EXPERIÊNCIA E EXCELÊNCIA

۲۲۸ ۵۵ ۸۱۸

WWW.SABATAM.COM

Wafer Butterfly Valve
Gear Operated, 300PSI
FIG · F0811 – 300

Specifications

- Single piece through shaft.
- Vulcanized seat design for bubble-tight shutoff at 300 psi.
- Flag type position indicator.
- Low torque operation, high cycle life.
- With built-in supervisory switch.
- Top flange to ISO 5211/1.
- Flanges to ANSI B16.1 Class125, EN1092-2 PN10/16. (Other types available upon request)
- UL Listed for size 2" - 12".
- FM Approved for size 2" - 6".

Working Pressure

- 300PSI.
- 200PSI and 250PSI available on request.

Working Temperature

- -10°C to 82°C.

Corrosion Protection

- Fusion Bonded Epoxy Coated Interior and Exterior to AWWA C550 Standard.

Notes:

Design and material are subject to change without notice.

Material Specifications

Part Name	Material	ASTM Spec.
Body	Ductile Iron	A536 65-45-12
Seat	Rubber	EPDM
Disc	Ductile Iron	A536 65-45-12
Shaft	Stainless Steel	AISI 431
Bushing	Brass	C67400
Gearbox Housing	Cast Iron	A126 Class B
Gearbox Cover	Cast Iron	A126 Class B
Wormgear	Bronze	C62300
Worm	Stainless Steel	AISI 316
Handwheel	Cast Iron	A126 Class B

Dimensions (mm / inch)

Size	A	B	D	E	C	F	G	H	L	M
2"	110 4.33	74 2.91	90 3.54	43 1.69	120 4.72	170 6.69	65 2.56	155 6.10	150 5.91	200 7.87
2.5"	118 4.65	85 3.35	90 3.54	46 1.81	120 4.72	170 6.69	65 2.56	155 6.10	150 5.91	200 7.87
3"	130 5.12	95 3.74	90 3.54	46 1.81	120 4.72	170 6.69	65 2.56	155 6.10	150 5.91	200 7.87
4"	145 5.71	115 4.53	90 3.54	52 2.05	120 4.72	170 6.69	65 2.56	155 6.10	150 5.91	200 7.87
5"	160 6.30	130 5.12	90 3.54	56 2.20	120 4.72	170 6.69	65 2.56	155 6.10	150 5.91	200 7.87
6"	175 6.89	145 5.71	90 3.54	56 2.20	120 4.72	170 6.69	65 2.56	155 6.10	150 5.91	200 7.87
8"	200 7.87	170 6.69	125 4.92	60 2.36	160 6.30	225 8.86	85 3.35	206 8.11	200 7.87	300 11.81
10"	250 9.84	208 8.19	125 4.92	68.5 2.70	160 6.30	225 8.86	85 3.35	206 8.11	200 7.87	300 11.81
12"	275 10.83	238 9.37	125 4.92	79.5 3.13	160 6.30	225 8.86	85 3.35	206 8.11	200 7.87	300 11.81

Schematic

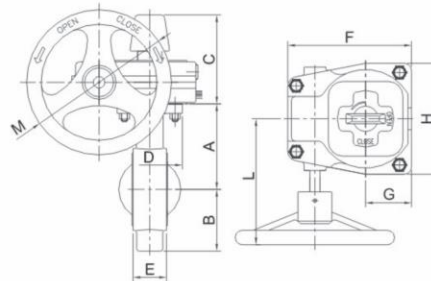

Installation sheet for Gear Operator With Tamper Switch

Butterfly valves are provided with internal supervisory position switches. The tamper switch operates by a cam connected to the valve stem. The switch will change position and close within two (2) full turns of the hand wheel from the fully open position.

Switch #1:

For connection to the supervisory circuit
Normally closed: 2 Yellow
Normally open: 2 Red
Common: 2 White

Switch #2:

Auxiliary switch connected per authority
Normally closed: 1 Blue
Normally open: 1 Orange
Common: 1 Black
Ground Lead: 1 Green

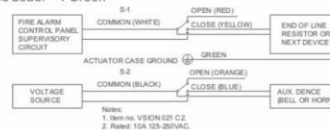

Wafer Butterfly Valve
Gear Operated, 300PSI
FIG · F0811 – 300

UL **ONLINE CERTIFICATIONS DIRECTORY**

HLXS.EX15503
Butterfly Valves

[Page Bottom](#)

Butterfly Valves

[See General Information for Butterfly Valves](#)

WEFLO VALVE CO LTD
Intersection of Huadong Rd and Chunyang Rd
Qingdao National High-tech Industrial Development Zone
QINGDAO, SHANDONG 266111 CHINA

EX15503

Model F0811-300 butterfly valves, sizes 2, 2.5, 3, 4, 5, 6, 8, 10 and 12 in. with wafer type end connection for aboveground installations having a rated pressure of 300, 250, 200 psig. The Model 2305 butterfly valves can be factory fitted with supervisory tamper switches for indoor/outdoor use.

Model F1022-300 butterfly valves, sizes 2, 2.5, 3, 4, 5, 6, 8, 10 and 12 in. with grooved type end connections for aboveground installations having a rated pressure of 300, 250, 200 psig. The Model 2905 butterfly valves can be factory fitted with supervisory tamper switches for indoor/outdoor use.

Trademark and/or Tradename: **WEFLO** , **Weilong**

[Last Updated](#) on 2015-08-28

[Questions?](#)

[Print this page](#)

[Terms of Use](#)

[Page Top](#)

2016 UL LLC

The appearance of a company's name or product in this database does not in itself assure that products so identified have been manufactured under UL's Follow-Up Service. Only those products bearing the UL Mark should be considered to be Certified and covered under UL's Follow-Up Service. Always look for the Mark on the product.

UL permits the reproduction of the material contained in the Online Certification Directory subject to the following conditions: 1. The Guide Information, Assemblies, Constructions, Designs, Systems, and/or Certifications (files) must be presented in their entirety and in a non-misleading manner, without any manipulation of the data (or drawings). 2. The statement "Reprinted from the Online Certifications Directory with permission from UL" must appear adjacent to the extracted material. In addition, the reprinted material must include a copyright notice in the following format: "© 2016 UL LLC".